

Safety Insulin Syringe (Manual Retractable)

Product Advantage:

- Safe:
 - * Retractable system prevents from needle-stick injuries;
 - * Self-destroy system prevents from reuse.
- Convenient:
 - * Activate the retractable device only with one hand;
 - * Easy readability, accurate and clear scale markings.
- Low residue, low waste.



Safety Secure:

- After injection, press the plunger harder until a click is heard.
- The needle will be engaged with the plunger and tilted in the barrel as pulling the plunger back.
- Until the first groove back to its position, snap off the plunger and dispose.
- The needle will be stuck and tilted in the barrel permanently.

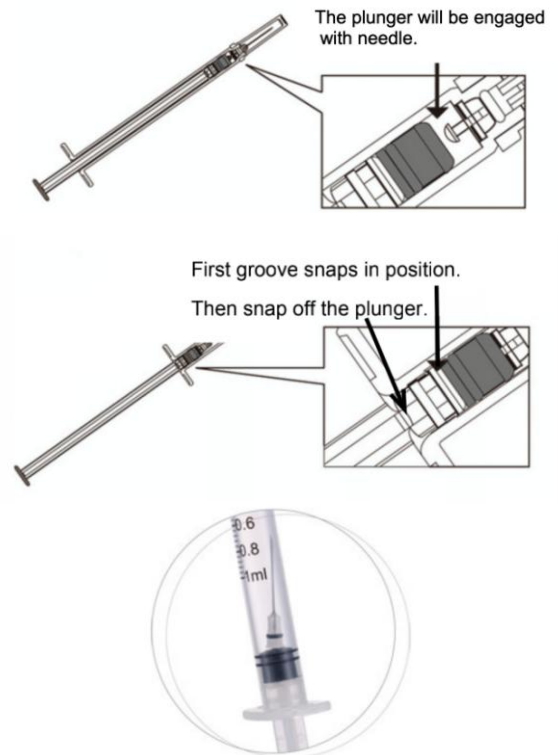

The risks from needle-stick injuries can largely decrease with other unsafe injection practices, such as needle reuse and improper medical waste collection.

Product Specification:

Size \ Gauge	Gauge					
	Length	27G	28G	29G	30G	31G
0.3ml	13mm	13mm	13mm	6mm, 13mm	6mm, 13mm	
0.5ml	13mm	13mm	13mm	6mm, 13mm	6mm, 13mm	
1ml	13mm	13mm	13mm	6mm, 13mm	6mm, 13mm	